



Solar Marine Navigation Light



Company profile

Shanghai Lansing Electronics Co., Ltd is a high-tech company engaged in LED outdoor light R&D, manufacturing and marketing. Our business scope mainly covers led aviation obstruction lights, led solar marine navigation lights, airport Lighting, led flood lights, led high bay lights and led street lights design and other fields.

Shanghai Lansing Electronics Co., Ltd has been the leader in the product quality and stability. We have a team of experts studying in LED outdoor lighting. Through the advanced technology, we have had rapid development for several years, investing huge sums of money and successfully developing and producing LED outdoor lighting. Our lighting will play an important part in the sustainable development of our company.

The strong ability of learning the new knowledge and resolving problems makes us as an energetic team; we are proud of the outstanding achievements in aviation obstruction lights, marine navigation solar lanterns, and other outdoor lighting.

Our mission is to change ourselves in thought and technology, then to light others. At first we must raise our identification ability about nature and humanity by repeating continuously this process: Learning, Practicing, Thinking, Solving; secondly, these ability can help us have a better life; finally, we can also help other people around us.

Our vision is to be the most reliable global provider of innovative solar and LED outdoor products, services and solution.

Drive quality into all we do;

Strictly abide by the principles of product design: easy operation, compact, endless reliability and durability;



Applications

Ideal for hazard marking, aquaculture, navigation, perimeter lighting & a host of other applications.

Specifications

Light Characteristics	
Intensity	10cd
Visible Range	>2.5nm
Available colors	Red, amber, green, blue or white(optional)
Vertical degree	>9°
Horizontal degree	360°
Light source	18*LEDS
LED life	≥100,000 hrs
Electrical Characteristics	
Autonomy	>10 days (12hour darkness, 12.5%duty cycle)
On/off level	300 lux±100lux
Flashing rate	complies to IALA Recommendations, Flashing sixth in 3 seconds
Power Supply	
Solar module type	Multicrystalline
Output	1.8 Watts
Battery type	Lithium battery
Battery capacity	3.7V/4.4AH
Physical Characteristics	
Integrated housing	UV resistance PC
Waterproof	IP67
Weight	1.9 KG
Ambient temperature	-30°C ~ +70°C
Size	D: 178mm, H: 228mm
Mounting dimension	Φ204-4XM8
Customized	External power or Infrared control

Features

- Based on LED technology, and its color complies to IALA Recommendations E-200-1.
- Integrated design, enabling a rugged and completely waterproof seal capable of prolonged and deep immersion (IP67).
- PC housing, UV resistance, shockproof and corrosion proof.
- With birds pike.
- With Steel wire to prevent falling during mounting and adjusting.
- With built in NiMH battery, easy for replace.
- No RF-radiations, EMC Compliant.
- Extremely Reliable and cost saving.

Mounting dimension (unit: mm)

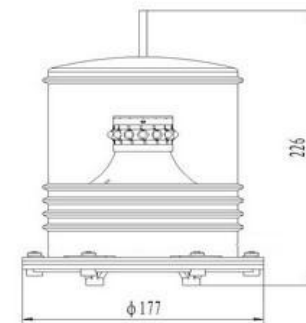



Product introduction

HB15 has become the most classical solar-powered LED Light in the field of marine aid to navigation around the world. Because of its self-contained, reliability and durability, it has also become a perfect model for all kinds of warning applications. It installs in minutes and requires no maintenance or servicing for up to five years. It complies with IALA-AISM's requirements.



Specifications

Light output		Steady On	Flashing
Peak Intensity (360° average) <i>Adjustable</i>	White	26cd	41cd
	Red	24cd	32cd
	Amber	20cd	27cd
	Green	25cd	39cd
	Blue	12cd	16cd
Visibility		2NM	3NM
Horizontal Output	360°		
Vertical Divergence	±7.5° at 50% intensity		
Minimum Autonomy		70Hours	140Hours
Latitude Range	55°S to 55°N		
On/Off Level	60/100 Lux		
Lifespan of LEDS	up to 100,000 Hours		
Solar Panel	1.5Watts mono-crystalline 16% efficiency		
Storage battery	Replaceable Ni-MH battery 2.4V4.8Ah		
Lens material	Polycarbonate		
Mounting Option	4 bolts or Magnetic base		
Weight	0.9kg		
Temperature Range	-40°C to +80°C		
Waterproof	IP67		
Quality control and Patents			
Quality Assurance	ISO9001:2008		



Features

- Available in red, amber, white and green
- Automatically turns on at dusk and off at dawn
- Completely self-contained and watertight
- Polycarbonate lens is virtually indestructible and anti-UV.
- Will charge under nearly all weather conditions and up to 120 hours of operating capacity from a full charge.
- Manufactured to ISO9001:2008 Quality Assurance standards
- Patented dome protects solar panel while improving efficiency, sheds snow.



Structure diagram



Product introduction

HB30 has become the most classical solar-powered LED Light in the field of marine aid to navigation around the world. Because of its self-contained, reliability and durability, it has also become a perfect model for all kinds of warning applications. It installs in minutes and requires no maintenance. The optical part is based on polycarbonate lens for better led transformation which can concentrate light to a small specific angel to meet 2.5nm visibility requirements. It complies with IALA-AISM's requirements. The service life can be guaranteed with more than 10 years by using the NiMH batteries.

Specifications

Minimum Autonomy	10 days (steady on) 20 days (flashing)
Visible distance	>2.5nm
Vertical Divergence	10 Degree
Horizontal	360 Degree
LED lifespan	100,000 Hours
Flash Pattern	Steady burning(default) or flashing mode(20-60 times/min)
Solar Panel	1.8W Solar module,mono-crystalline with 14%efficiency
Storage battery	3.6V8AH ,High-efficiency NiMH battery
Lens	Polycarbonate, UV Stabilize
Base Material	Die-casting Aluminum
Water-proof	IP68
Temperature Range	-40C° ~ +55C°
Warranty	5 years for light 2 years for NiMH battery Available with GPS Synchorinzation function

Features

- Based on LED technology, and its color complies to IALA Recommendations E-200-1
- Integrated design, enabling a rugged and completely waterproof seal capable of prolonged and deep immersion (IP68)
- PC housing resistance, shockproof and corrosion proof.
- With built in lead acid battery, easy for replace.
- Will charge under nearly all weather conditions and up to 200 hours of operating capacity from a full charge.
- No RF-radiations, EMC Compliant.

Structure diagram

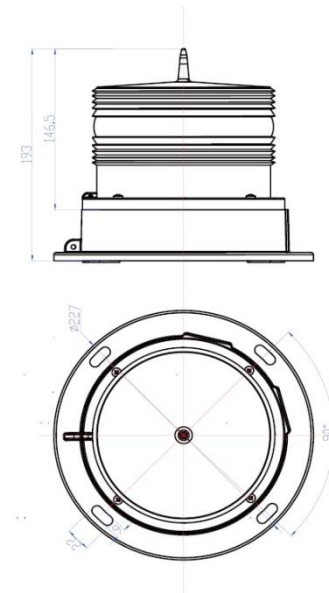

Applications

- High rise building marking
- Road obstruction marking
- Port, dock entrance&walkway
- Offshore gas&oil platform
- Telecom tower marking
- Navigation aid
- Buoy marking

Product introduction

HB05 is an economical solar navigation light providing 360 degrees of lighting for identifying docks, navigation aides or obstructions at night. It's widely to be used as a warning light to control traffic, be inserted into top of traffic one, or locked to traffic barrier by using metal bracket.

HB05 use ultra-bright F5 LEDs as light source, made from an anti-UV polycarbonate optical housing with chrome plated reflective cup inside, to produce a bright light visible from over 500m away during night time operation. PVC Reflector on the housing helps light itself to be seen easier. It offers superior water resistance (IP68 can be into water) with silicone O ring & button cap.

Specifications

SPECIFICATION	
Lamp size:	157 x 90mm
Material:	Anti-UV PC shell
Design:	optical housing + chrome plated reflective cup
Light source:	Ultra-bright F5 LED
Solar module:	Large laminated mono-crystalline 0.45W
Battery:	Fe battery

Features

- Maintenance-free; solar powered
- Visibility over 500m
- Easily installed by metal bracket
- Strong PC housing IP68 rated
- White, Red, Blue, Green, Amber, with colored reflector
- 18 hours operation (constant ON) after one day of charging Automatically turns ON at dusk
- Constant ON or Flashing Operation (Optional)



ITEM NO.	WORKING MODE
HB-05:	Flash- Constant ON - OFF
HB-05 RBW:	Red – Blue – White in a light
RBW Flash -R F -B F -W F – R ON – B ON – W ON – 0FF	
INSTALLATION	
A. Locked by metal bracket MB	
B. Inserted into traffic cone top or dia.>31mm pole.	

Applications

- High rise building marking
- Telecom tower marking
- Road obstruction marking
- Navigation aid
- Port, dock entrance&walkway
- Buoy marking
- Offshore gas&oil platform

Product introduction

HB06 is an economical solar navigation light providing 360 degrees of lighting for identifying docks, navigation aides or obstructions at night. It also can be used as a warning light to control traffic.

HB06 is a high brightness warning light using 8 pcs of F5 LEDs to produce a bright light visible from over 2NM away during night time operation. It offers superior water resistance (IP65) through the use of an elevated internal base and rubber O ring. The shell is made from an anti-UV polycarbonate optical housing and features an anti-bird barb.

Specifications

SPECIFICATION	
Lamp size:	149 x 131mm (168mm with spike)
Material:	Anti-UV PC shell + ABS base
Design:	Hidden base inside of housing selects Constant-On & Flash
Light source:	8pcs F5 LED
Solar module:	Large laminated mono-crystalline 1W
Battery:	2400mAh lithium cell (replaceable)

Features

- Maintenance-free; solar powered
- 8pcs LED with optical shell, super bright
- Visibility over 2nm (3700m)
- Strong ABS case IP65 rated
- Available colors: White, Red, Blue, Green, Amber (Optional)
- Over 30 hours operation after one day of charging
- Automatically turns ON at dusk
- Constant On or Flashing Operation (selectable)
- With the support(Optional)

ITEM NO.	WORKING MODE
HB-06:	Constant On – -Flash-OFF
OPERATION:	Push-button on underside
	Selects Constant On & Flash
INSTALLATION	
Flat mounted:	4pcs M4x30 screws(Included)
Magnetic base:	Optional

Metal Mounting Base

- 2 sizes: 150mm (11.8”) or 300mm (5.9”)
- Strong steel construction with anti-rust coating
- Fits several models of solar warning lights
- Easy to mount warning light using 4 x M4 bolts
- Mounts to deck surfaces using 4 x M8 bolts
- Access hole permits use of on/off/ mode buttons



Applications

- High rise building marking
- Telecom tower marking
- Road obstruction marking
- Navigation aid
- Port, dock entrance&walkway
- Buoy marking
- Offshore gas&oil platform

Product introduction

HB32 has become the most classical solar-powered LED Light in the field of marine aid to navigation around the world. Because of its self-contained, reliability and durability, it has also become a perfect model for all kinds of warning applications. It installs in minutes and requires no maintenance or servicing for up to five years. The optical part is based on polycarbonate lens for better led transformation which can concentrate light to a small specific angel to meet 3-4nm visibility requirements. It complies with IALA-AISM's requirements.

Features

- Based on LED technology, and its color complies to IALA Recommendations E-200-1.
- Integrated design, enabling a rugged and completely waterproof seal capable of prolonged and deep immersion (IP68).
- PC housing resistance, shockproof and corrosion proof.
- With built in lead acid battery, easy for replace.
- With Steel wire to prevent falling during mounting and adjusting
- Will charge under nearly all weather conditions and up to 200 hours of operating capacity from a full charge.
- No RF-radiations, EMC Compliant.
- Extremely Reliable and cost saving.

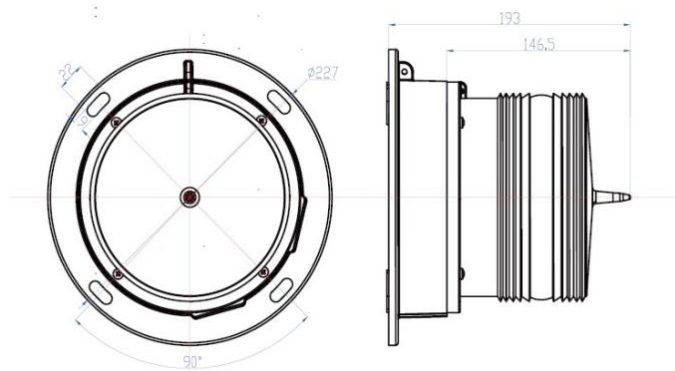

Specifications

LIGHT OUT-PUT	
Nominal Night Range	3-4 Nautical mile
LED Color Available	Red, green, yellow, blue or white(optional)
Vertical Divergence	10 Degree
Horizontal Out-put	360 Degree
Illumination	Ultra-bright LEDs
LED Lifespan	100,000 Hours
OPERATION	
Autonomy	3-4 days(steady on) 15days(flashing)
On & Off Level	70/100 Lux
Flash Pattern	20-90FPM (Preprogrammed default 40FPM)/fixed type
POWER SUPPLY	
Power Source	Solar module, mono-crystalline silicon
Solar Efficiency	14%
Max. Power Out-put	4.8 Watts
Battery Type	High-efficiency NiMH battery
Battery Capacity	3.6V8AH
Battery Replacement	Yes, replaceable
MECHANICAL STRUCTURE	
Lens	Polycarbonate, UV Stabilize
Body	Die-casting Aluminum
Water-proof	IP68
Temperature Range	-40C ~ +55C
Warranty	5 years for light, 2 years for NiMH battery

Product introduction

HB50 Solar marine light has become the most classical solar-powered LED Light in the field of marine aid to navigation around the world. Because of its self-contained, reliability and durability, it has also become a perfect model for all kinds of warning applications. It installs in minutes and requires no maintenance or servicing for up to five years. It complies with IALA-AISM's requirements

This light has built in GPS module, and several lights can synchronize at the same time(optional).

Specifications

Effective Intensity	50cd
Visibility	4-7NM
Minimum Autonomy	25 days (flashing), 8 days(steady on)
Vertical Divergence	10 Degree
Horizontal	360 Degree
Power source	Solar module, mono-crystalline silicon
LED color	Red, green, yellow, blue or white(optional)
LED lifespan	100,000 Hours
Flash Pattern	20-90FPM (Preprogrammed default 40FPM)
Solar Panel	18V/4*5W Solar module, mono-crystalline silicon with 14%efficiency
Storage battery	12V12AH, replaceable High-efficiency Lithium rechargeable battery
MACHANICAL STRUCTURE	
Lens	Polycarbonate, UV Stabilize
Body	Die-casting Aluminum
Water-proof	IP67
Net Weight	6.8KG
Gross weight	7.6KG
Temperature Range	-40C° ~ +55C°
Warranty	5 years for light,2 years for lithium battery

Features

- Based on LED technology, and its color complies to IALA Recommendations E-200-1.

- Integrated design, enabling a rugged and completely waterproof seal capable of prolonged and deep immersion (IP67).
- Visible distance is more than 3-7 Nautical miles.
- 256 kinds of flashing rate are available, compliance with IALA (optional) .
- With photocell, which can switch on/off the light automatically at dawn and dusk .
- With built in NIMH battery, maintenance free and easy for replace.
- With GPS Synchronization(optional)
- PC housing resistance, shockproof and corrosion proof.

Applications

- High rise building marking
- Road obstruction marking
- Port, dock entrance & walkway
- Offshore gas & oil platform
- Telecom tower marking
- Navigation aid
- Buoy marking

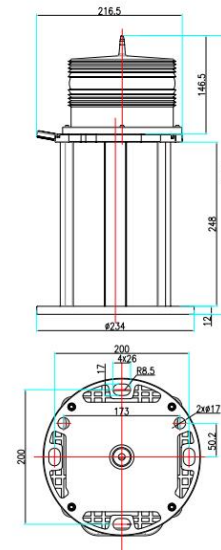

Product introduction

HB60 has become the most classical solar-powered LED Light in the field of marine aid to navigation around the world. Because of its self-contained, reliability and durability, it has also become a perfect model for all kinds of warning applications. It installs in minutes and requires no maintenance or servicing for up to five years. It complies with IALA-AISM's requirements.

This light has built in GPS module(optional), and several lights can synchronize at the same time.

Specifications

Effective Intensity	32.5cd
Visibility	3-5NM
Minimum Autonomy	15 days
Vertical Divergence	10 Degree
Horizontal	360 Degree
Power source	Solar module, mono-crystalline silicon
LED color	Red, green, yellow, blue or white(optional)
LED lifespan	100,000 Hours
Flash Pattern	20-90FPM (Preprogrammed default 40FPM)/fixed type
Solar Panel	10W Solar module, mono-crystalline silicon with 14% efficiency
Storage battery	8.8AH/3.7V, replaceable Lithium battery
MACHANICAL STRUCTURE	
Lens	Polycarbonate, UV Stabilize
body	Die-casting Aluminum
Water-proof	IP68
Net Weight	4.6KG
Gross weight	6.5KG
Temperature Range	-40C° ~ +55C°
Warranty	5 years for light 2 years for NiMH battery

Features

- Based on LED technology, and its color complies to IALA Recommendations E-200-1.
- Integrated design, enabling a rugged and completely waterproof seal capable of prolonged and deep immersion (IP68).
- Visible distance is more than 3-5 Nautical miles.
- With photocell, which can switch on/off the light automatically at dawn and dusk .
- With built in NIMH battery, maintenance free and easy for replace.
- Once fully charged, it can work for up to 15 days.
- With GPS Synchronization(optional).

Applications

- High rise building marking
- Road obstruction marking
- Port, dock entrance & walkway
- Offshore gas & oil platform
- Telecom tower marking
- Navigation aid
- Buoy marking

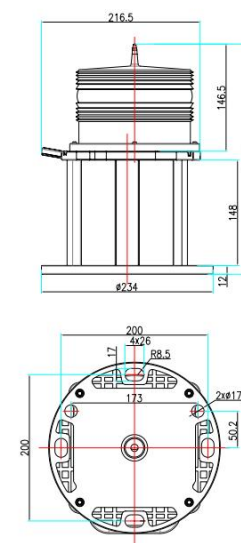

Product introduction

HB80 Solar marine light has become the most classical solar-powered LED Light in the field of marine aid to navigation around the world. Because of its self-contained, reliability and durability, it has also become a perfect model for all kinds of warning applications. It installs in minutes and requires no maintenance or servicing for up to five years. It complies with IALA-AISM's requirements This light has built in GPS module, and several lights can synchronize at the same time (optional) .

- Based on LED technology, and its color complies to IALA Recommendations E-200-1.
- Integrated design, enabling a rugged and completely waterproof seal capable of prolonged and deep immersion (IP67).
- Visible distance is more than 7-10 Nautical miles.
- 256 kinds of flashing rate are available, compliance with IALA(optional)
- With photocell, which can switch on/off the light automatically at dawn and dusk .
- With GPS Synchronization(optional)

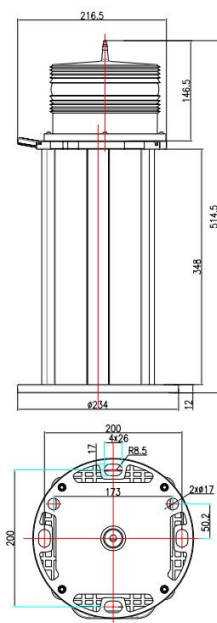

Specifications

SPECIFICATIONS	
Light Model	HB80
Effective Intensity	1600cd
Visibility	7-10NM
Minimum Autonomy	25 days (flashing), 8 days(steady on)
Vertical Divergence	10 Degree
Horizontal	360 Degree
Power source	Solar module, mono-crystalline silicon
LED color	Red, green, yellow, blue or white(optional)
On & Off Level	70/100 Lux
LED lifespan	100,000 Hours
Flash Pattern	20-90FPM (Preprogrammed default 40FPM)
Solar Panel	18V/4*6W Solar module, mono-crystalline silicon with 14%efficiency
Storage battery	12V14AH, replaceable High-efficiency Lithium rechargeable battery
MECHANICAL STRUCTURE	
Lens	Polycarbonate, UV Stabilize
Body	Die-casting Aluminum
Water-proof	IP67
Net Weight	9.8KG
Gross weight	12KG
Temperature Range	-40C° ~ +55C°
Warranty	5 years for light ,2 years for Lithium battery

Product introduction

HB30-RF has become the most classical solar-powered LED Light in the field of marine aid to navigation around the world. Because of its self-contained, reliability and durability, it has also become a perfect model for all kinds of warning applications. It installs in minutes and requires no maintenance. The optical part is based on polycarbonate lens for better led transformation which can concentrate light to a small specific angel to meet 4nm visibility requirements. It complies with IALA-AISM's requirements.

The service life can be guaranteed with more than 10 years by using the NiMH batteries.

Specifications

Minimum Autonomy	20 days
Visible distance	>4nm(flashing type) >2.5nm(steady on)
Vertical Divergence	10 Degree
Horizontal	360 Degree
LED lifespan	100,000 Hours
Flash Pattern	20-90FPM (Preprogrammed default 40FPM) or fixed type
Solar Panel	1.8W Solar module, mono-crystalline with 14%efficiency
Storage battery	8Ah , replaceable High-efficiency NiMH battery
Lens	Polycarbonate, UV Stabilize
Base Material	Die-casting Aluminum
Water-proof	IP68
Temperature Range	-40C° ~ +55C°
Warranty	5 years for light ,2 years for NiMH battery

Features

- Unique optical design complies with IALA, with 256 flashing patterns for selection
- Based on LED technology, and its color complies to IALA Recommendations E-200-1
- Integrated design, enabling a rugged and completely waterproof seal capable of prolonged and deep immersion (IP68).
- PC housing resistance, shockproof and corrosion proof.
- With Steel wire to prevent falling during mounting and adjusting
- With built in lead acid battery, easy for replace.
- Will charge under nearly all weather conditions and up to 200 hours of operating capacity from a full charge.
- No RF-radiations, EMC Compliant.



Applications

- High rise building marking
- Road obstruction marking
- Port, dock entrance&walkway
- Offshore gas&oil platform
- Telecom tower marking
- Navigation aid
- Buoy marking

Product introduction

HB50-RF Solar marine light has become the most classical solar-powered LED Light in the field of marine aid to navigation around the world. Because of its self-contained, reliability and durability, it has also become a perfect model for all kinds of warning applications. It installs in minutes and requires no maintenance or servicing for up to five years. It complies with IALA-AISM's requirements.

This light has built in GPS module, and several lights can synchronize at the same time(optional).

Features

- Based on LED technology, and its color complies to IALA Recommendations E-200-1.
- Integrated design, enabling a rugged and completely waterproof seal capable of prolonged and deep immersion (IP67).
- Visible distance is more than 3-7 Nautical miles.
- With photocell, which can switch on/off the light automatically at dawn and dusk .
- 256 kinds of flashing rate are available, comply with IALA.
- With built in NIMH battery, maintenance free and easy for replace.
- GSM faulty alarm function(optional)
- With GPS Synchronization(optional)



Specifications

Effective Intensity	50cd
Autonomy	25 days (flashing), 8 days(steady on)
Visible distance	4-7NM
Vertical Divergence	10 degree
Horizontal out-put	360 Degree
LED color	Red, green, yellow, blue or white(optional)
Illumination	Ultra-bright LEDs
LED lifespan	100,000 Hours
Solar Panel	18V/4*5W Solar module mono-crystalline silicon with 14% efficiency
Battery type	High-efficiency Lithium rechargeable battery
Storage battery	12V/12Ah , replaceable battery
Lens	Polycarbonate, UV Stabilized
Base Material	Die-casting Aluminum
Water-proof	IP67
Net Weight	6.8KG
Gross weight	7.6KG
Temperature Range	-40C° ~ +55C°
Dimensions	414.5mm H, 234mm Diameter
On & Off Level	70/100 Lux
Flash Pattern	20-90FPM (Preprogrammed default 40FPM)
Warranty	5 years for light ,2 years for lithium battery

Product introduction

HB50-RF Solar marine light has become the most classical solar-powered LED Light in the field of marine aid to navigation around the world. Because of its self-contained, reliability and durability, it has also become a perfect model for all kinds of warning applications. It installs in minutes and requires no maintenance or servicing for up to five years. It complies with IALA-AISM's requirements.

This light has built in GPS module, and several lights can synchronize at the same time (optional) ,and also provide the 256 flashing patterns that comply with IALA

Features

- Based on LED technology, and its color complies to IALA Recommendations E-200-1.
- Integrated design, enabling a rugged and completely waterproof seal capable of prolonged and deep immersion (IP68).
- Visible distance is more than 3-5 Nautical miles.
- With photocell, which can switch on/off the light automatically at dawn and dusk .
- Once fully charged, it can work for up to 15 days
- With built in NIMH battery, maintenance free and easy for replace.
- GSM faulty alarm function(optional)
- With GPS Synchronization(optional)



Specifications

Effective Intensity	32.5cd
Autonomy	15 days
Visible distance	3-5NM
Vertical Divergence	10 degree
Horizontal out-put	360 Degree
LED color	Red, green, yellow, blue or white(optional)
Illumination	Ultra-bright LEDs
LED lifespan	100,000 Hours
Solar Panel	10 W Solar module mono-crystalline silicon with 14% efficiency
Battery type	Lithium battery
Storage battery	8.8AH/3.7V , replaceable battery
Lens	Polycarbonate, UV Stabilized
Base Material	Die-casting Aluminum
Water-proof	IP68
Net Weight	4.6KG
Gross weight	6.5KG
Temperature Range	-40C° ~ +55C°
Dimensions	278mm H, 235mm Diameter
On & Off Level	70/100 Lux
Flash Pattern	20-90FPM (Preprogrammed default 40FPM)/fixed type
Warranty	5 years for light ,2 years for lithium battery

Product introduction

HB80 Solar marine light has become the most classical solar-powered LED Light in the field of marine aid to navigation around the world. Because of its self-contained, reliability and durability, it has also become a perfect model for all kinds of warning applications. It installs in minutes and requires no maintenance or servicing for up to five years. It complies with IALA-AISM's requirements This light has built in GPS module, and several lights can synchronize at the same time (optional) .

Features

- Based on LED technology, and its color complies to IALA Recommendations E-200-1.
- Integrated design, enabling a rugged and completely waterproof seal capable of prolonged and deep immersion (IP67).
- Visible distance is more than 7-10 Nautical miles.
- 256 kinds of flashing rate are available, compliance with IALA(optional)
- With photocell, which can switch on/off the light automatically at dawn and dusk .
- With built in NIMH battery, maintenance free and easy for replace.
- GSM faulty alarm function(optional)
- With GPS Synchronization(optional)



Specifications

Effective Intensity	1600cd
Visibility	7~10NM (adjustable)
Minimum Autonomy	25 days (flashing), 8 days(steady on)
Vertical Divergence	10 Degree
Horizontal	360 Degree
Power source	Solar module, mono-crystalline silicon
LED color	Red, green, yellow, blue or white(optional)
On & Off Level	70/100 Lux
LED lifespan	100,000 Hours
Flash Pattern	20-90FPM (Preprogrammed default 40FPM)
Solar Panel	18V6W*4pcs Solar module,mono-crystalline with 14% efficiency
Storage battery	12V14AH, High-efficiency Lithium rechargeable battery
Lens	Polycarbonate, UV Stabilize
Body	Die-casting Aluminum
Water-proof	IP67
Net Weight	9.8KG
Gross Weight	12KG
Temperature Range	-40C° ~ +55C°
Warranty	5 years for light ,2 years for Lithium battery

Product introduction

GL10 has become the most classical LED Light in the field of marine aid to navigation around the world. Because of its reliability and durability, it has also become a perfect model for all kinds of warning applications. It installs in minutes and requires no maintenance. The optical part is based on polycarbonate lens for better led transformation which can concentrate light to a small specific angel to meet 2.5nm visibility requirements. It complies with IALA-AISM's requirements. The service life can be guaranteed with more than 10 years by using high quality LED.

Features

- Based on LED technology, and its color complies to IALA Recommendations E-200-1.
- Integrated design, enabling a rugged and completely waterproof seal capable of prolonged and deep immersion (IP67).
- LED light source ensures long lifetime, maintenance free
- Corrosion resistant lamp & housing-suitable for off-shore use
- Self-contained compartment-eliminates additional box
- Built in surge protection, can withstand an over voltage of 10kV/10kA
- No RF-radiations, EMC Compliant.
- Extremely Reliable and cost saving.



Specifications

Effective Intensity	10cd
Visibility	>2.5NM
Input voltage	110-220VAC, 50/60 Hz;12VDC;24VDC;30-60VDC
Vertical Divergence	10 Degree
Horizontal	360 Degree
Frequency	50Hz ~ 60Hz
LED color	Red,yellow, green, blue or white(optional)
LED lifespan	100,000 Hours
Flash Pattern	Steady burning or flashing type(20-60times/min available)
Lens	Polycarbonate, UV Stabilize
Body	Die-casting Aluminum
Water-proof	IP67
Weight	0.9KG
Relative humidity	100% with condensation
Temperature Range	-40C° ~ +55C°
Wind speed	Up to 150mph(240kph)
Warranty	5 years

Product introduction

GL32 has become the most classical LED Light in the field of marine aid to navigation around the world. Because of its reliability and durability, it has also become a perfect model for all kinds of warning applications. It installs in minutes and requires no maintenance. The optical part is based on polycarbonate lens for better led transformation which can concentrate light to a small specific angel to meet 5nm visibility requirements. It complies with IALA-AISM's requirements. The service life can be guaranteed with more than 10 years by using high quality LED.

Features

- Based on LED technology, and its color complies to IALA Recommendations E-200-1.
- Integrated design, enabling a rugged and completely waterproof seal capable of prolonged and deep immersion (IP67).
- LED light source ensures long lifetime, maintenance free
- Corrosion resistant lamp & housing-suitable for off-shore use
- Self-contained compartment-eliminates additional box
- Built in surge protection, can withstand an over voltage of 10kV/10kA
- No RF-radiations, EMC Compliant.
- Extremely Reliable and cost saving.



Specifications

Effective Intensity	32.5cd
Visibility	>5NM
Input voltage	110-220VAC, 50/60 Hz;12VDC;24VDC;30-60VDC
Vertical Divergence	10 Degree
Horizontal	360 Degree
Frequency	50Hz ~ 60Hz
LED color	Red,yellow, green, blue or white(optional)
LED lifespan	100,000 Hours
Flash Pattern	Steady burning or flashing type(20-60times/min available)
Lens	Polycarbonate, UV Stabilize
Body	Die-casting Aluminum
Water-proof	IP67
Weight	0.9KG
Relative humidity	100% with condensation
Temperature Range	-40C° ~ +55C°
Wind speed	Up to 150mph(240kph)
Warranty	5 years

Product introduction

GL50 has become the most classical LED Light in the field of marine aid to navigation around the world. Because of its reliability and durability, it has also become a perfect model for all kinds of warning applications. It installs in minutes and requires no maintenance. The optical part is based on polycarbonate lens for better led transformation which can concentrate light to a small specific angel to meet 7nm visibility requirements. It complies with IALA-AISM's requirements. The service life can be guaranteed with more than 10 years by using high quality LED.

Features

- Based on LED technology, and its color complies to IALA Recommendations E-200-1.
- Integrated design, enabling a rugged and completely waterproof seal capable of prolonged and deep immersion (IP67).
- LED light source ensures long lifetime, maintenance free
- Corrosion resistant lamp & housing-suitable for off-shore use
- Self-contained compartment-eliminates additional box
- Built in surge protection, can withstand an over voltage of 10kV/10kA
- No RF-radiations, EMC Compliant.
- Extremely Reliable and cost saving.



Specifications

Effective Intensity	>50cd
Visibility	>7NM
Input voltage	110-220VAC, 50/60 Hz;12VDC;24VDC;30-60VDC
Vertical Divergence	10 Degree
Horizontal	360 Degree
Frequency	50Hz ~ 60Hz
LED color	Red,yellow, green, blue or white(optional)
LED lifespan	100,000 Hours
Flash Pattern	Steady burning or flashing type(20-60times/min available)
Lens	Polycarbonate, UV Stabilize
Body	Die-casting Aluminum
Water-proof	IP67
Weight	1.1KG
Relative humidity	100% with condensation
Temperature Range	-40C° ~ +55C°
Wind speed	Up to 150mph(240kph)
Warranty	5 years

Product introduction

GL100 has become the most classical LED Light in the field of marine aid to navigation around the world. Because of its reliability and durability, it has also become a perfect model for all kinds of warning applications. It installs in minutes and requires no maintenance. The optical part is based on polycarbonate lens for better led transformation which can concentrate light to a small specific angel to meet 10nm visibility requirements. It complies with IALA-AISM's requirements. The service life can be guaranteed with more than 10 years by using high quality LED.

Features

- Based on LED technology, and its color complies to IALA Recommendations E-200-1.
- Integrated design, enabling a rugged and completely waterproof seal capable of prolonged and deep immersion (IP67).
- LED light source ensures long lifetime, maintenance free
- Corrosion resistant lamp & housing-suitable for off-shore use
- Self-contained compartment-eliminates additional box
- Built in surge protection, can withstand an over voltage of 10kV/10kA
- No RF-radiations, EMC Compliant.
- Extremely Reliable and cost saving.



Specifications

Effective Intensity	>100cd
Visibility	>10NM
Input voltage	110-220VAC, 50/60 Hz;12VDC;24VDC;30-60VDC
Vertical Divergence	10 Degree
Horizontal	360 Degree
Frequency	50Hz ~ 60Hz
LED color	Red,yellow, green, blue or white(optional)
LED lifespan	100,000 Hours
Flash Pattern	Steady burning or flashing type(20-60times/min available)
Lens	Polycarbonate, UV Stabilize
Body	Die-casting Aluminum
Water-proof	IP67
Weight	1.2KG
Relative humidity	100% with condensation
Temperature Range	-40C° ~ +55C°
Wind speed	Up to 150mph(240kph)
Warranty	5 years